

Towards a democratic landscape transformation of the Elaionas Plain in Athens

OLA Intensive Programme Final Presentation May 31, 2024
Agricultural University of Athens

Team members: Eutuxia Alevizaki (AUA), Amin Farzinfar (UNIBO),
Renáta Gergály (MATE), Philipp Gülzow (HSWT), Maria Kakara (AUA),
Maja Schittig (HSWT), Sára Szekér (MATE), Nina Wiedemann (HSWT)

Tutors: Ellen Fetzer, Dirk Funck (HfWU)
Anna Szilágyi-Nagy (KulturAktiv)



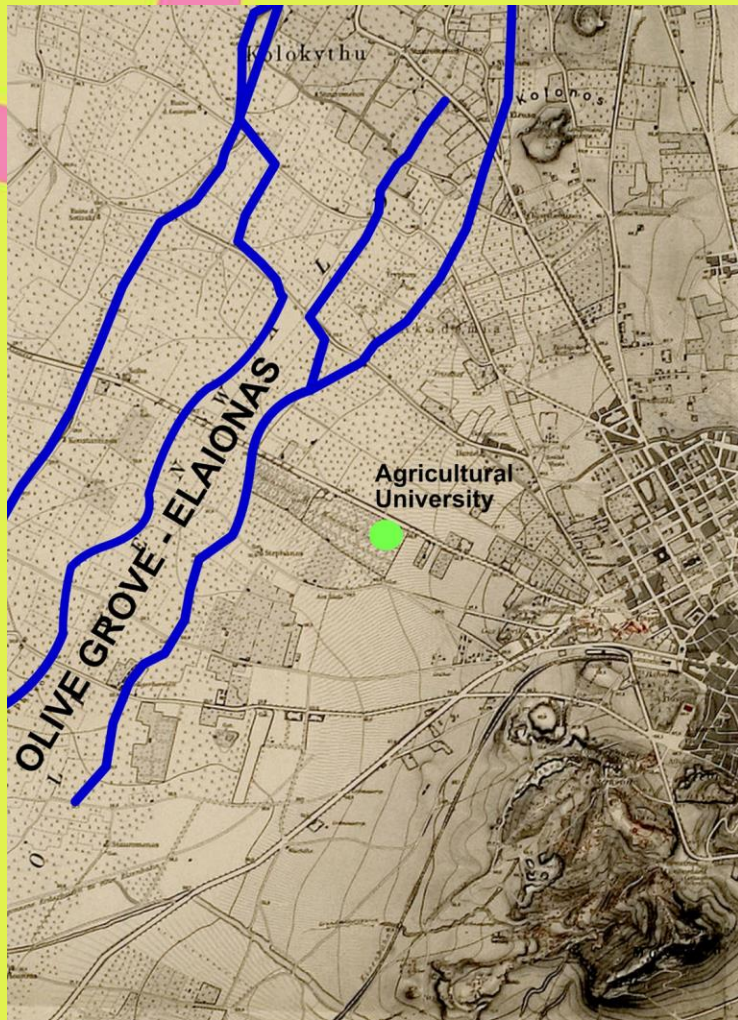

Eleionas used to be an olive grove, hence the name Eleionas

This is the floodplain of the Kifisos river, its branches used to water the olives.

Most of the streams and brooks are invisible, underground or strongly neglected today.

A new Landscape Governance Model for Elaionas

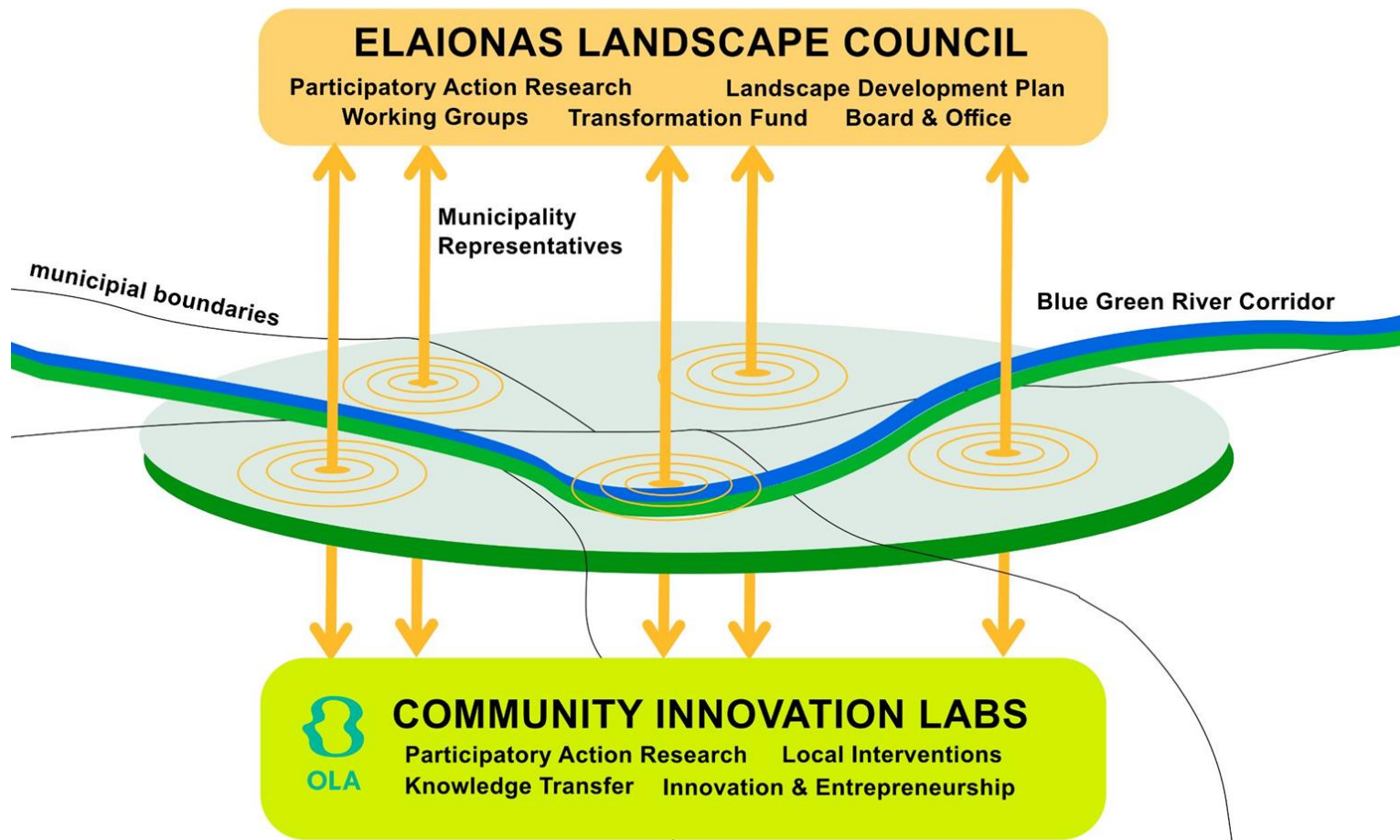

The vision of the Elaionas Landscape Council

Our vision is a healthy, inclusive and resilient Eleonas landscape that **leaves nobody behind** during the regeneration process.

At the heart of this landscape we see the forgotten and hidden **rivers**. They will become ecological , social, climatic and cultural **corridors**.

Eleonas will have a powerful **green infrastructure network** that supports its social, ecological and cultural **regeneration**.

We see a landscape of circular and **regenerative production** that provides opportunities for many including the **most vulnerable** and deprived. Eleonas **stands together** for a common future.

The mission of the Elaionas Landscape Council

We do this through the innovative and landscape-based governance of the Elaionas Landscape Council. Our Council is formed by representatives of **all five municipalities** belonging to the Elaionas plain.

Our Council is steered by **democratically legitimated goals and principles** that are in line with its vision.

This informs the **strategy-building, landscape development planning and co-funding** of transformative designs and practices in Elaionas.

The council works in close collaboration with local **Community Innovation Labs**. These labs operate at the interface of **science, people and landscape**. They provide **inclusive entry points** to diverse social groups.

They can become an active part of the democratic landscape transformation of Elaionas.

Principles of the Elaionas Landscape Development Plan

- Activate all rivers as **blue-green corridors**
- Apply the **3 - 30 - 300 rule** for green infrastructure, health and climate resilience
- Create a connected and multifunctional **green infrastructure network**
- Keep the productive landscape in a new form: **green economy**, food, light & circular fabrication, clean & decarbonised
- Envision a **new modal split**: 30% car, 40% public transport, 30% cycling & foot
- Enhance the **antique heritage**: Via Sacra and Olive Grove
- No more soil sealing. **Regenerate 30% of the sealed surface**
- Develop **residential functions** and affordable housing
- Built **new university facilities** on places that need transformation
- Use **Community Innovation Labs** to test principles and activate capacity

The background is a solid teal color. It features four large, white, thick-lined geometric shapes: a pentagon on the left, a hexagon on the top right, a trapezoid on the bottom right, and a square on the bottom left. The text is centered in the middle of the page.

Master Plan Vision 2060

Master Plan Vision 2060





















0 200 400 600

commonspace

TECNOLÓGICO DIAMANTERMINO JOHANN
MAGNIFICENTIA UNIVERSITY OF BRNO

OLIA



-  Main Streets
-  Small Streets
-  Additional Greenery/
Pedestrian
-  Riverfront development
-  current Greenery
-  Regenerated
large scale
Building
-  Train Trak
-  Train Station
-  Metro Trak
-  Metro Station
-  Stadium
-  Campus landscape
Developments with
regenerated Buildings
-  Bus Hub
-  Labor Association
-  Desinfection Center
-  Plato tree
-  sacred way
-  Pedestrian connection

A possible spatial transition: 2024

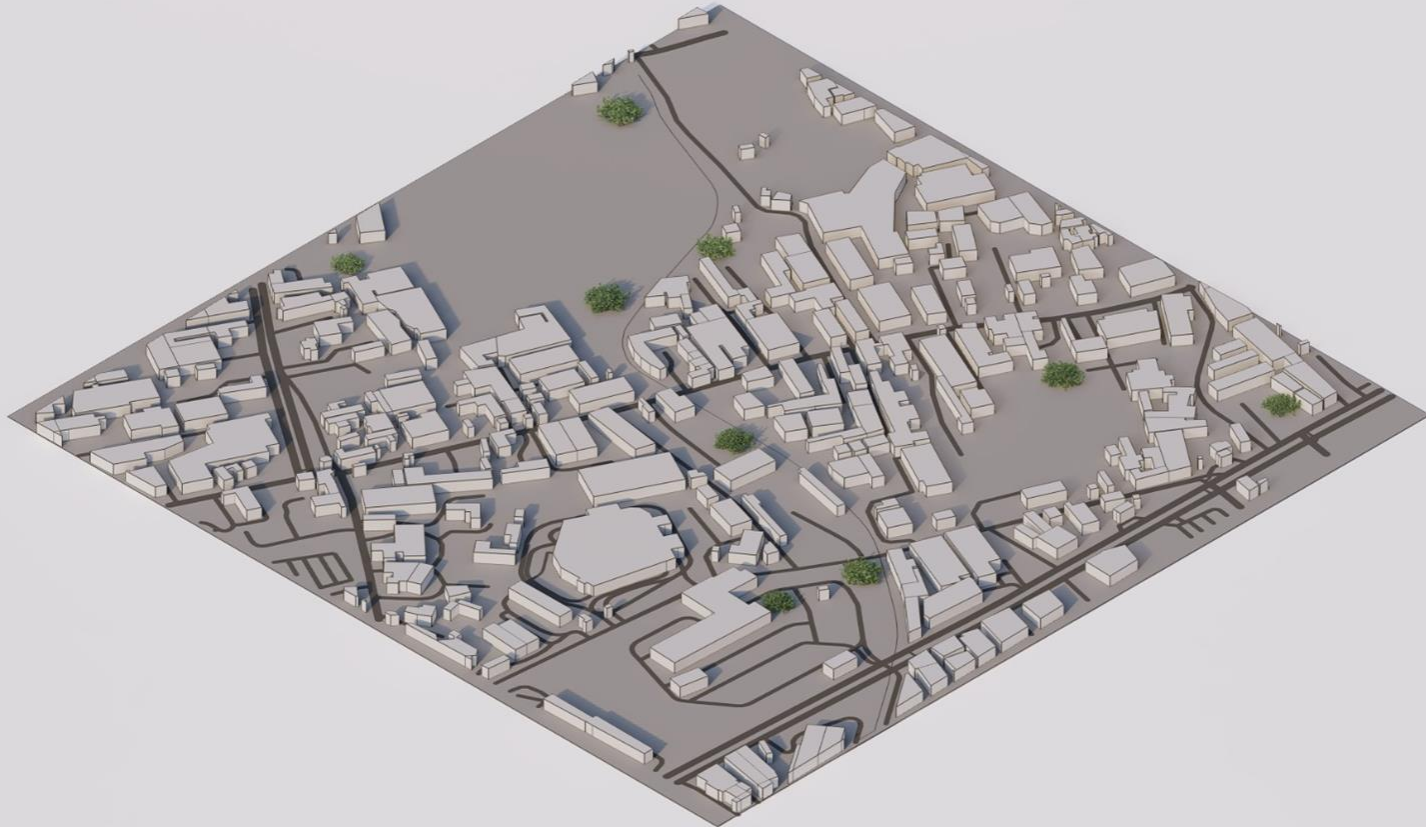

A possible spatial transition: 2040



A possible spatial transition: 2060



Cross-section of the river in 2024

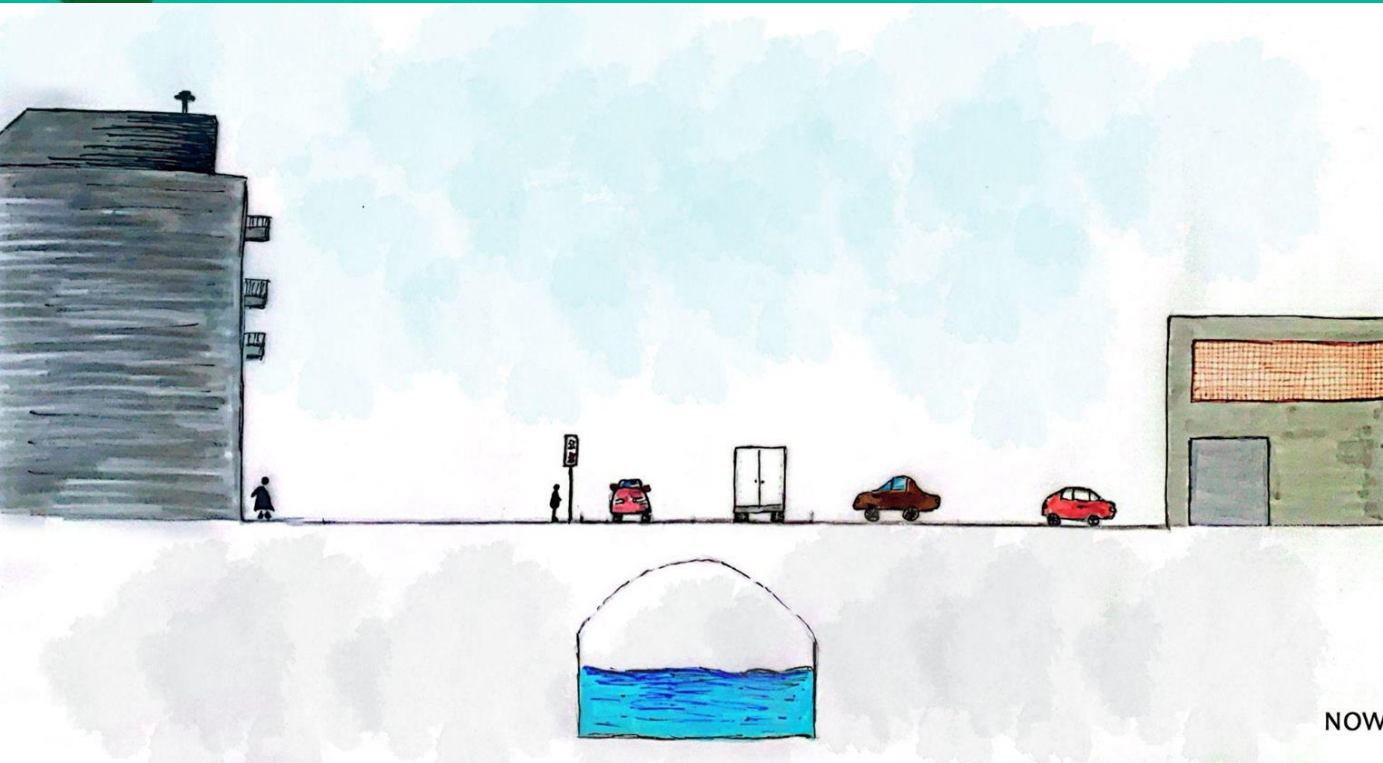

- Lot of cars
- Empty spaces everywhere
- Underground river
- Abandoned factories
- Lack of green areas

Cross-section of the river in 2040

- Bringing the river to the surface
- Adding trees and plants to the side of the river



Cross-section of the river in 2060



- Turning empty spaces and abandoned factories into green areas
- Smoothing out the riverbanks for access to the river
- Bringing life to the green areas with letting people gather there

Cross-section of the street near the university 2024

- Narrow dark tunnel
- Big street
- Lot of traffic
- No safe way to cross the street without the tunnel

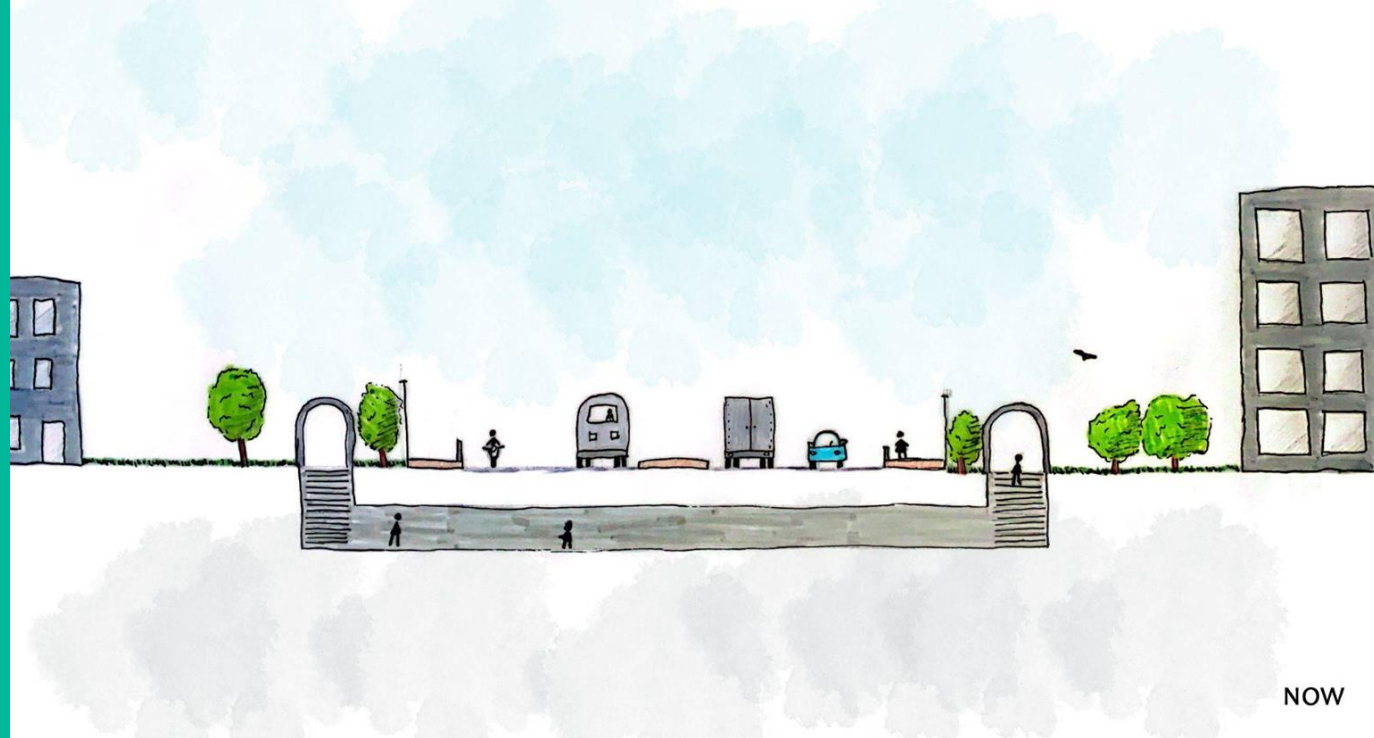

Cross-section of the street near the university 2040



- Traffic light for crossing
- Plant trees and plants on the “traffic island”

Cross-section of the street near the university 2060

- Narrow down the street - more place for green
- Plant trees and plants on the “traffic island”
- Having a bus stop to have easy access to the meto (cultural meaning - columns)



Cross-sections of the landscape in transition



Elaionas NexUs^{*}

center for social and landscape transformation



former disinfection center

Elaionas NexUs creates a strong network of inspired people, companies and institutions in and around Elaionas. Based on a close cooperation with the university and the sense of participatory action research we develop and offer formats to design an inclusive democratic decision pathway to activate the resources of the society and the landscape for a sustainable development.

^{*}*nexus* (Latin): something which binds, binding, bond, fastening, joint.



governance

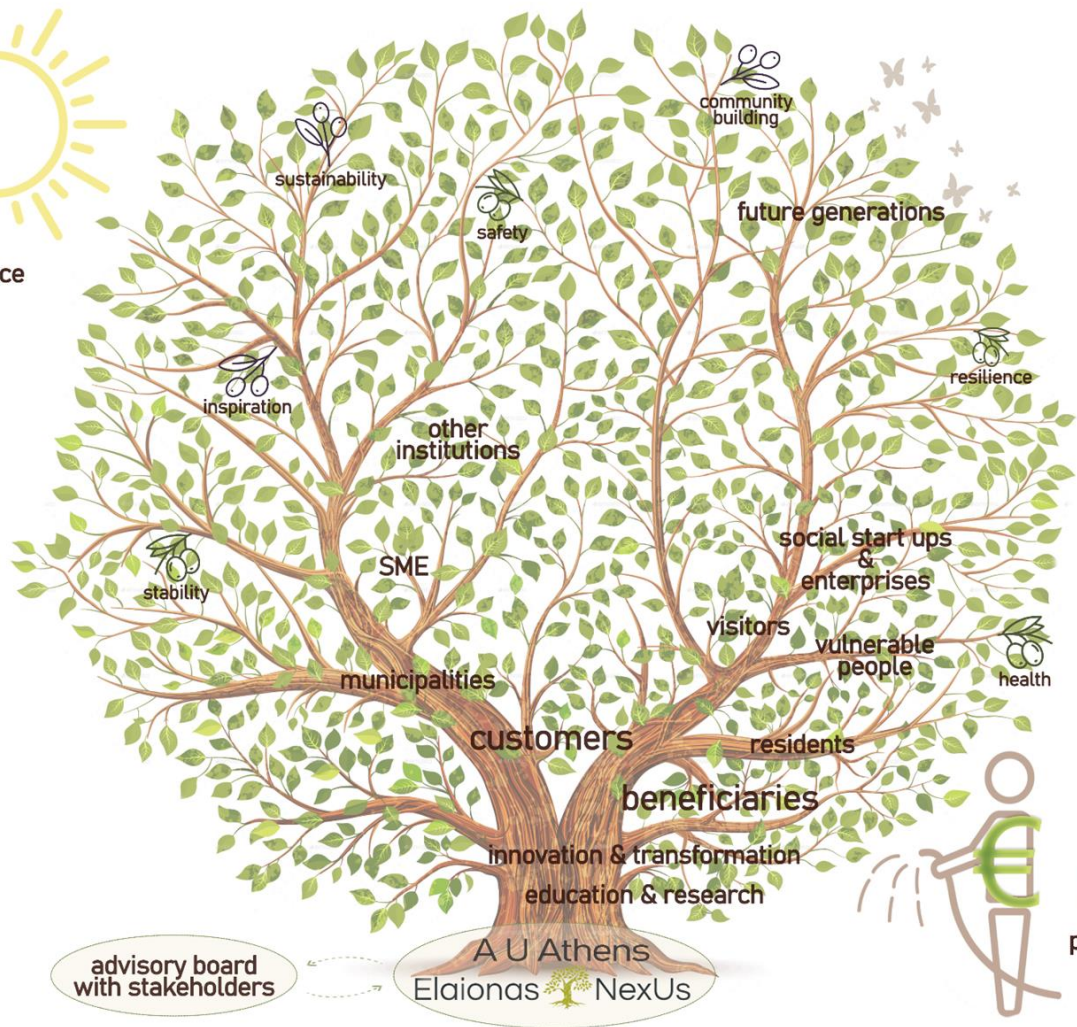

Elaionas  NexUs

our concept



partners

Elaionas NexUs : Our Offers and Revenue Streams



development and management of a regional network with online platform for knowledge sharing and participatory GIS



consultancy/moderation/mediation on issues relating to participation processes and sustainable transformation



educational and certification programmes



organization and hosting of conferences, summits, workshops and community events



software development



application and implementation of research and transfer projects



support for (social) start-ups in the foundation phase



co-working space



meeting-point with café



in addition:
sponsoring
and funding

How do we work: local food chain (example)

AUA

EU, National,
Local, Private

Research
Transfer

Applications
Funding

Elaionas  NexUs

Networking
Workshops, Co-
Working
Seminars, Training

Consulting
Participation

Elaionas
Community

Municipalities



Schools, Residents,
Local Businesses, Local
Organisations

Elaionas
Landscape Council



2060



2040



2024

